

SL2380

ScreenLine[®] Owner sKit

Blind control device
Battery module



Installe r
guide

Morley
GLASS & GLAZING LIMITED

www.pellini.net

The battery module SL2380 supplies power to the 'F' system ScreenLine motorised blind.

The solar panel SL1084B160 (option) is used to recharge the battery module SL2380 on a continuous basis.

Wiring and installation must be fitted by skilled staff only.

Pellini SpA accepts no liability for damage caused by improper installation.

INSTALLATION ON THE WINDOW FRAME

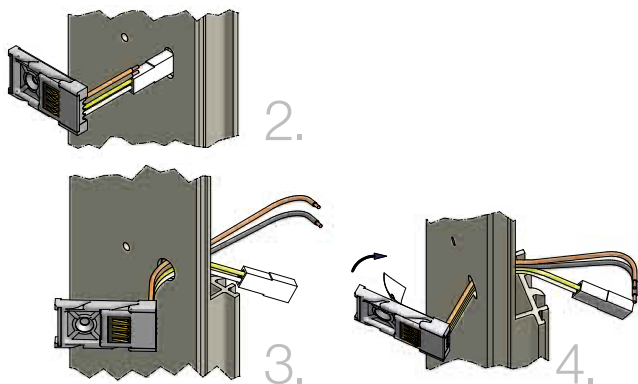
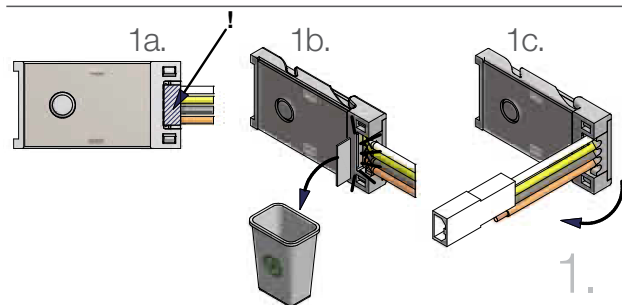
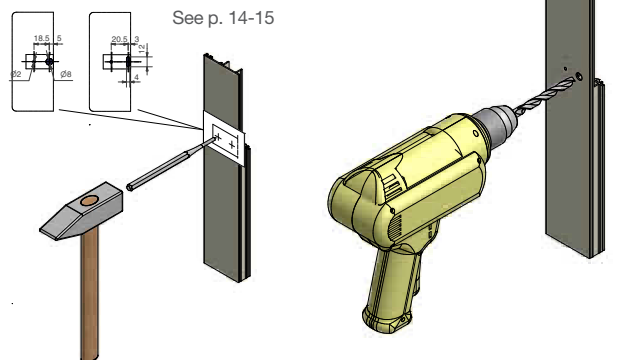

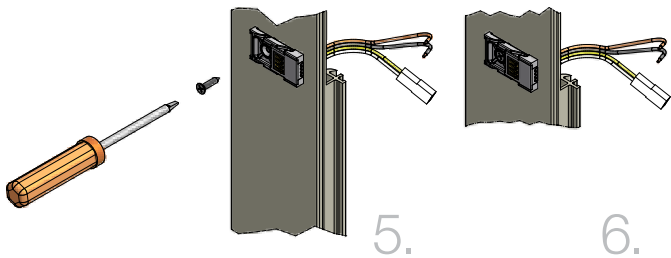

INSTALLATION ON GLASS

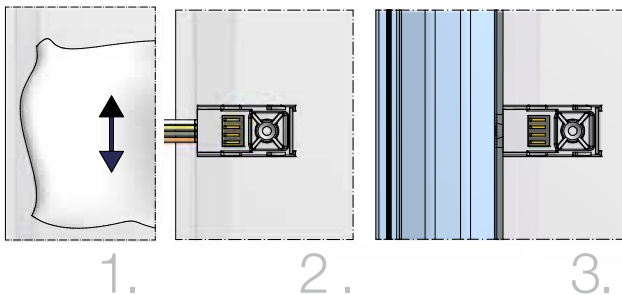

WITH GASKET

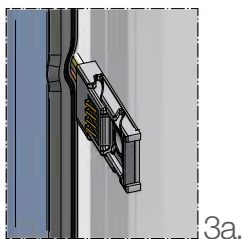

FLUSH EDGE GASKET

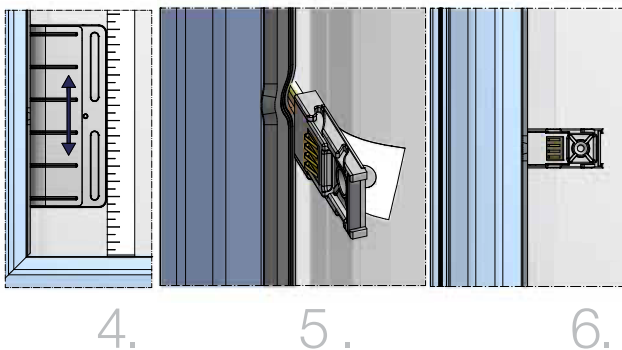
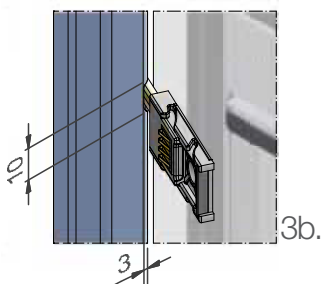

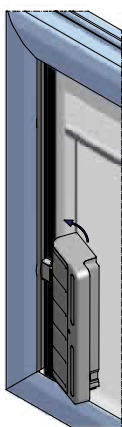
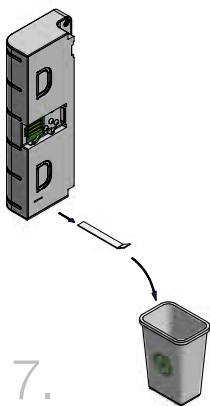

8a.

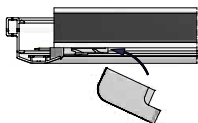

8b.

8.

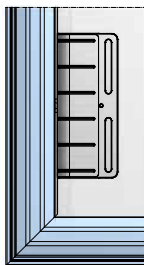

9.

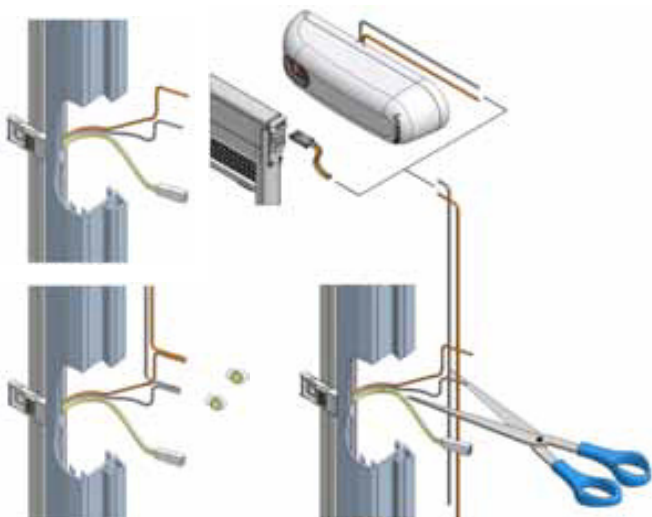

MOTOR CONNECTION THROUGH INSULATED CRIMP WIRE CONNECTORS

It is possible to use other types of connection (e.g. screw block terminals, insulated crimps, insulated heat shrinkable wire connectors, etc), provided that they ensure a stable contact and wire insulation.

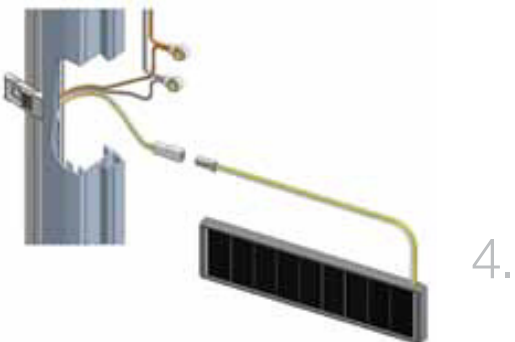
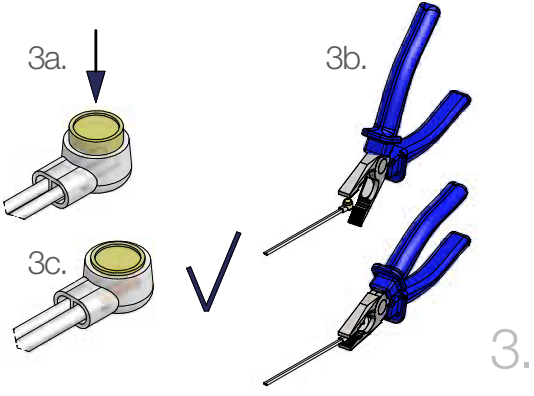
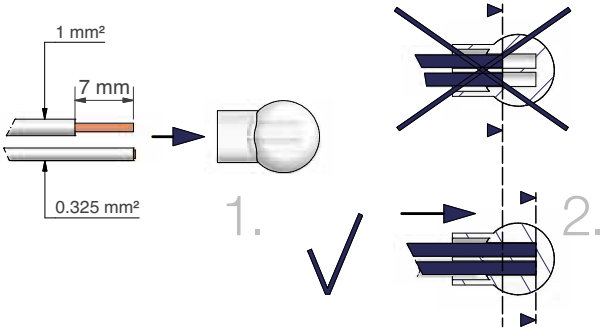

SWITCHING ON

The battery module is fitted with a plastic strip that isolates the batteries in the OFF position.

To switch the battery module ON, remove the plastic strip.

Correct function is indicated by the LED, which lights up for about 3 seconds. During this time interval, device will carry out internal check and calibration procedures: Please do not touch, **rest your hand or any other object on the sensitive areas indicated.**

If the sensor is not working properly, carry out the recalibration procedure (see below), again taking care not to touch the sensitive area.

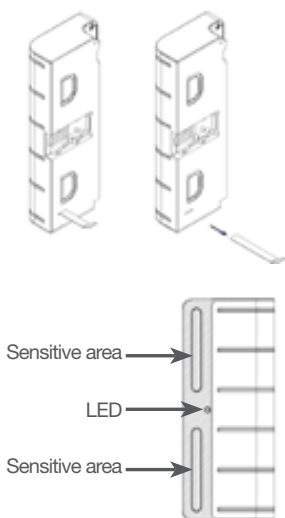

RECHARGING THE BATTERIES

The module is delivered with the batteries partially charged: it is therefore necessary to put them through at least one complete charge cycle.

When supplied with a solar panel (optional): during the normal operating cycle, the solar panel helps keep the battery module charged. In certain cases, e.g. photovoltaic panel positioned on the north side of the building or in a shady area, intense use, or very low temperatures, it may be necessary to recharge the batteries using the power adaptor provided.

If the batteries need recharging, the LED will flash following an up or down command.

Recharging is automatically is controlled by the battery module.

To recharge the batteries:

1. Detach the battery module from the base plate
2. Plug the power adapter into a power socket
3. Plug the micro-USB connector into the port provided on the module.

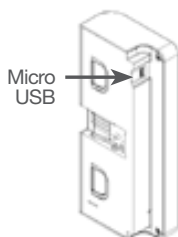

When the power adaptor is connected, the LED will indicate the following conditions:

- LED flashing: batteries missing, defective or not of a compatible type.
Immediately unplug the adapter
- LED pulsating: charging underway
- LED steadily lit: charging completed

After charging, detach the cable and fit the module back onto its base plate.

IMPORTANT: this action will start a sensor recalibration cycle; therefore, be careful not to touch the sensitive areas until the LED goes off.

In the case of new batteries, 2-3 complete charging/discharging cycles may be needed to bring the batteries to full capacity.

PROGRAMMING THE REMOTE CONTROL (OPTIONAL)

The battery module can be supplied with a radio remote control receiver (SL2377) as a standard feature; alternatively the receiver can be installed at a later date (see dedicated installation instructions).

A 99-channel radio transmitter (PCB) is used for the remote control.

The radio receiver positioned inside the battery module can memorize up to 58 channels; it can thus receive an equal number of addresses from one or more remote controls.

To program the remote control follow the instructions provided below.

Memorizing a channel

1. Detach the battery module from the support
2. Select the required channel on the remote control transmitter display by pressing the +/- buttons
3. Press the button on the battery module until the respective LED lights up
4. Release the button
5. Simultaneously press the up and down keys on the remote control transmitter
6. Wait until the LED starts flashing slowly to indicate that the channel has been memorised and release the buttons.

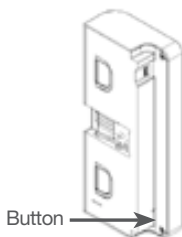

Deleting a channel

1. Detach the battery module from the support
2. Call up the channel to be deleted on the remote control display by pressing the +/- buttons
3. Keep the button on the battery module pressed until the LED starts flashing quickly after lighting up
4. Release the button
5. Simultaneously press the up and down keys on the remote control transmitter.
6. Wait until the LED starts flashing slowly to indicate that the channel has been deleted and release the buttons.

Deleting all of the channels

1. Detach the battery module from the support
2. Keep the button on the battery module pressed until the LED starts flashing more slowly after flashing quickly
3. Release the button
4. All the previously memorized channels will be deleted

For further instructions on using the remote control, refer to the specific instruction manual.

RECALIBRATION OF THE BATTER MODULE - SENSITIVE AREA

If the battery module is not working properly you can recalibrate the sensitive area by carrying out one of the following procedures:

1. Detach the battery module from the support
2. Plug the power adapter into a power socket
3. Plug the micro-USB connector into the port provided on the module.
4. Pull out the connector

Or else

1. Detach the battery module from the support
2. Remove the battery compartment cover
3. Remove one of the batteries and then replace it
4. Fit the battery back in place

IMPORTANT: during recalibration do not place your hand or any other object on the sensitive area.

During recalibration the LED will remain lit for about three seconds; when it goes out, the procedure is complete.

If the battery module is reprogrammed for logic inversion (see

paragraph below) the LED will light up briefly, go off and then light up again for 3 seconds.

LOGIC INVERSION

The battery module incorporates a digital accelerometer which automatically detects the position of the module on the frame and adapts the functions of the touch-sensitive area.

The normal operating mode requires the battery module to be mounted on the frame / glass on the same side as the motor, with the rounded part toward the outside of the frame.

If the battery module is installed horizontally, it is assumed that the motor is positioned on top right.

- N.B. (1) For blinds with internal motors there may be some circumstances where it necessary to invert the operating logic.
- (2) When used with the external motor SL2190 no adjustments are necessary.

Those cases where the logic must be inverted are:

- module installed in a horizontal position and blind equipped with internal motor positioned top left.
- module installed on left side of frame and blind equipped with internal motor positioned on the right
 - module installed on right side of frame and blind equipped with internal motor positioned on the left
 - module installed on same side as internal motor but in a reversed position (rounded part toward the inside of the frame)

To invert the operating logic, carry out the following procedure:

1. Detach the battery module from the support
2. Plug the power adapter into a power socket
3. Connect the power adapter to the micro-USB port on the battery module
4. Press the button on the module with a paper clip and keep it pressed
5. Disconnect the power adapter

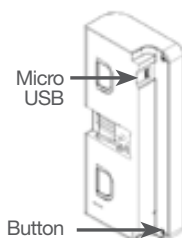

6. Wait until the LED starts flashing and then goes off
7. Release the button

IMPORTANT: this action will start a sensor recalibration cycle; therefore, be careful not to touch the sensitive areas until the LED goes off.

During recalibration, watch the LED: it will light up briefly, go off and then light up again for 3 seconds to indicate that the procedure was successfully completed. To check the configuration of the battery module at any time, carry out the recalibration procedure, keeping an eye on the LED.

MAINTENANCE

The product requires no maintenance, except for replacement of the rechargeable batteries as necessary. Any repairs must be made by a technician authorized by Pellini SpA.

In the event of prolonged inaction, remove the batteries.

CLEANING

Clean the product using a clean, dry, soft cloth that does not leave any residues. To remove stubborn dirt, you can slightly moisten the cloth with warm water. Do not use solvent-containing detergents. Do not clean the gold-plated contacts with alcohol or other substances.

REPLACING THE BATTERIES

To replace the batteries use the following procedure:

1. Detach the battery module from the support
2. Remove the battery compartment cover by pressing in the area indicated and sliding in the direction shown
3. Remove the spent batteries

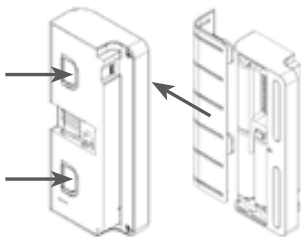

4. Insert the new batteries, paying attention to the direction of insertion indicated on the bottom of the battery compartment. To avoid the risk of damaging the module, do not touch the exposed electronic parts.
5. Before inserting the last battery, be careful not to rest your hand or any other object on the sensitive area since as soon as all the batteries have been inserted the module will become 'live' and immediately and automatically carry out a recalibration. If the module is not working properly, carry out the recalibration procedure.
6. Place the cover back on the battery compartment
7. Fit the battery module back onto the support

WARNING! It is essential to keep and follow the following instructions to ensure people's safety!

- Use only rechargeable "AA" 1.2V 2700 mAh NI-MH batteries of good quality.
- Do not use lithium, alkaline or lead-zinc batteries. The use of these types of batteries may damage the device, cause leakage of acid substances and generate a fire hazard
- Do not use batteries of different capacities or brands together and always replace all three batteries simultaneously.

ANY FAILURE TO OBSERVE INSTRUCTIONS OR TAMPERING WITH THE BATTERY MODULE WILL INVALIDATE THE WARRANTY.

DISPOSAL OF BATTERIES

Spent batteries must be safely disposed of in the special waste containers or collection areas provided (refer to the regulations in force in the town or city where they will be disposed of). The batteries must be removed from the device before their disposal. If any acid leaks from the batteries, take them out, gently clean off any traces of liquid present on the PCB or contact plates using a soft cloth and alcohol and replace the old batteries with new ones.

DISPOSAL OF THE DEVICE

According to the provisions of Directive 2002/96/EC the battery module is to be considered as belonging to the category of WEEE (Waste Electrical and Electronic Equipment): it thus cannot be disposed of as unsorted municipal waste. At the end of its lifetime, the device must be taken to one of the separate waste collection centres for waste electrical and electronic equipment from households. Make reference to the collection centres in your town or city, which assures that suitable, accessible, functional separate collection systems are set up to enable end consumers and retailers to dispose of the waste produced within the municipal territory free of charge.

INFORMATION ABOUT PROPER USE

The battery module is supplied for the purpose of operating Pellini “F Touch” blinds with an internal motor (or external motor on other systems).

Any use for other than the intended purpose is to be considered improper use.

The manufacturer accepts NO liability for damage caused by improper use.

SAFETY INFORMATION

WARNING! It is essential to keep and follow the following instructions to ensure people's safety!

The device must not be used by children or individuals with physical, sensory or mental impairments.

The device must also not be used by individuals who have no experience or knowledge about how it is used without the supervision of a person responsible for their safety.

The device is not a toy: keep it out of children's reach!

DO NOT force the device to work if any repairs or adjustments are needed.

DO NOT attempt any do-it-yourself repairs: repairs must be carried out by authorized personnel only.

DO NOT leave the module unattended while the batteries are charging.

DO NOT throw spent batteries into a fire: they could explode.

DO NOT open or perforate or short circuit the batteries.

Use only NI-MH rechargeable batteries.

WARNING! THE USE OF UNSUITABLE BATTERIES MAY CAU-

SE THEM TO EXPLODE!

If any liquids penetrate into the device or in the event of damage of any other kind, immediately take out the batteries and return the device to the manufacturer for inspection.

In the event of prolonged inaction of the device, remove the batteries

Technical data

Battery module SL2380

3x1.2Vd.c. Ni-MH AA 2700mAh; 1.5VA;

Battery charger:

Primary: 100-240V ac 50/60Hz 15VA

Secondary: 5V 2A dc



DRILLING TEMPLATES

Round hole

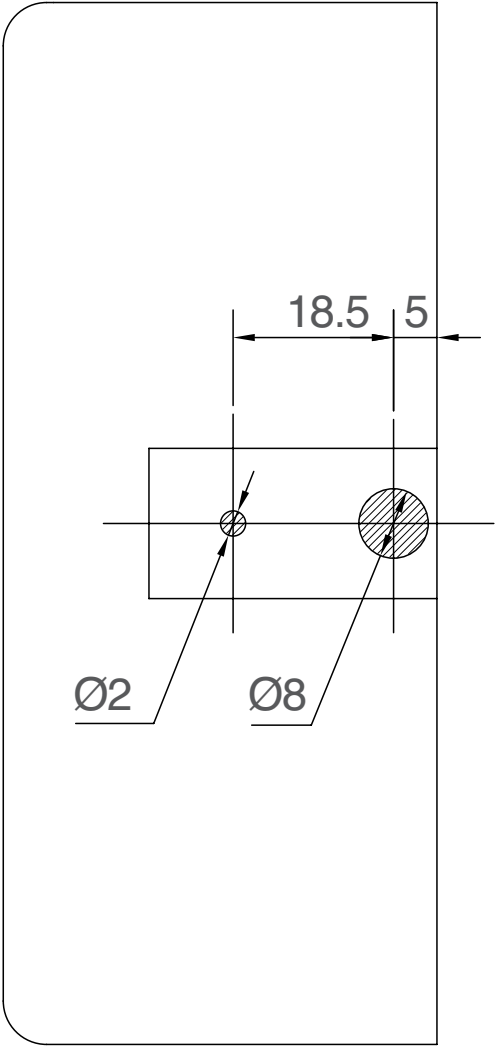

Milled hole

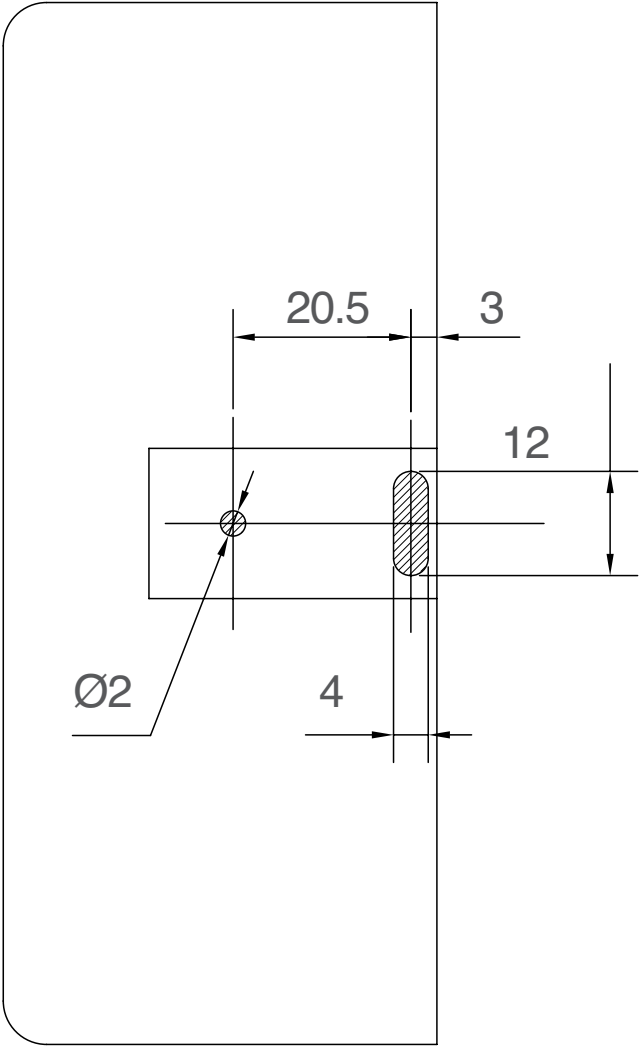

Uni-Blinds®



Morley

GLASS & GLAZING LIMITED

Unit 27, Millshaw Park Industrial Estate,
Millshaw Park Drive, Leeds LS11 0LU
Tel: 0113 277 8722 • Fax: 0113 277 8723
Email: info@morleyglass.co.uk
www.morleyglass.co.uk

pellini®industrie

Pellini S.p.A.
Via Fusari, 19
26845 Codogno • Lo • Italia
T. +39 0377 466411
F. +39 0377 436001
info@pellini.net - www.pellini.net