

58BW FLUSH HI Window



The 58BW Flush window combines minimal sightlines and maximum weather resistance with all the best features of the tried and trusted 58BW range: advanced performance, versatility and security.

With a choice of slim sashes and a range of configuration options, the flush finish and slim sightlines of the 58BW Flush make this the perfect choice for contemporary new-build and refurbishment projects.

A double rebate provides market-leading weather performance, even in more exposed locations, and the 58BW Flush utilises common hardware with the existing 58BW and Heritage ST window ranges to ensure it can withstand a range of weather conditions.

The 58BW Flush shares the same sashes, features and hardware with the 70mm frame option for the 58BW suite, making it quicker and easier to fabricate with just three new profiles.

DESIGN FEATURES

- › Advanced weather performance – features like the double rebate, and friction stays on side-hung windows offer protection against bad weather conditions
- › Slimmer sightlines – 45mm ultra-slim sash suits a range of property styles
- › Unique polyamide thermal break design to improve thermal performance
- › Certified under the Secured by Design scheme
- › Tested to PAS 24

OPTIONS

- › Open-out sashes including top and side-hung.
- › The flush shadow line can be complimented with a choice of flat, putty line or stepped edge (crittal style) vent styles to suit the property
- › Available in a range of standard and RAL colours.
- › Stock offer - readily available on a 5-day lead time in colours 9910HG, 7016M, and 9005M as well as dual colour white/grey and white/black.

SPECIFICATIONS

| Performance and accreditations | 58BW FLUSH HI |
|--------------------------------|-----------------------|
| U-Value (Double Glazing) | 1.4 W/m²K |
| U-Value (Triple Glazing) | 1.2 W/m²K |
| Window Energy Rating (WER) | B - C |
| BRE Green Guide Rating | A rated |
| Air Permeability | Class 4 (600 Pa) |
| Water Tightness | Class 9a (600Pa) |
| Wind Resistance | Class E2400 (2400 Pa) |
| Security | PAS 24 |
| 3rd Party Certification Q-Mark | ✓ |

System

| | |
|-------|------|
| Depth | 70mm |
|-------|------|

Configurations

| | |
|-----------------|----------|
| Opening | Open-Out |
| Top Hung | ✓ |
| Side Hung | ✓ |
| Bottom Hung | ✓ |
| Dummy Sashes | ✓ |
| Fixed Light | ✓ |
| Multi Light | ✓ |
| French Casement | ✓ |

Size and weight limits

Top Hung

| | |
|---------------|---------------|
| Max Size (mm) | 1750w x 2500h |
| Min. Size | 300w x 350h |
| Max Weight | 180kg |

Side Hung

| | |
|---------------|---------------|
| Max Size (mm) | 1300w x 1750h |
| Min. Size | 300w x 300h |
| Max Weight | 55kg |

Fixed Light

| | |
|---------------|-------|
| Max Size (mm) | - |
| Min. Size | - |
| Max Weight | 250kg |

Glazing

| | |
|---------------------|---------------------|
| Glazing Options | Internal & External |
| Glazing Thickness** | 24mm-40mm |

System Features

| | |
|-------------------------------------|-------|
| Single Colour | ✓ |
| Dual Colour | ✓ |
| Textured Finish | ✓ |
| Anodised Finish | ✓ |
| Multi-Point Locking | ✓ |
| Sightline (Frame to Vent) | 98mm |
| Sightline (Vent to Mullion to Vent) | 113mm |
| Sightline (Dummy Sash) | 158mm |
| Sightline (Fixed Light) | 53mm |

**Glazing thickness: Other thicknesses may be possible dependant on profile combinations specified. Fabricators should refer to AluK technical manual glazing section for details.

CAD CROSS SECTIONS AND THERMAL PROFILE

Additional details are available on request.

58BW FLUSH HI HEAD

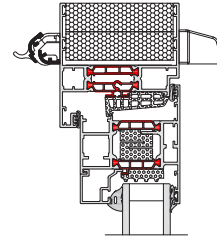

58BW FLUSH HI JAMB

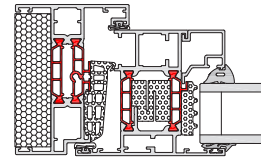

58BW FLUSH HI MULLION

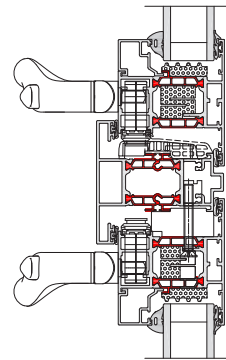

58BW FLUSH HI THERMAL PROFILE

